

MHz RANGE CRYSTAL UNIT



Product Number (please contact us)
Q21CA3011xxxx00

CA-301

- Frequency range : 4 MHz to 64 MHz
- Thickness : $\phi 3.1$ mm Max.
- Overtone order : Fundamental
3rd overtone (30 MHz to 64 MHz)
- Applications : For Clock of integrated circuit

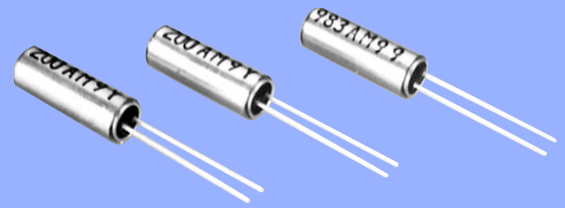

Actual size



Specifications (characteristics)

Item	Symbol	Specifications	Conditions / Remarks
Nominal frequency range	f _{nom}	4.000 MHz to 29.999 MHz	Fundamental *1
		30.000 MHz to 64.000 MHz	3rd overtone *2
Storage temperature	T _{stg}	-40 °C to +85 °C	Storage as single product.
Operating temperature	T _{use}	-20 °C to +70 °C	The operating temperature range is -10 °C to +60 °C for 5.5 MHz and below
Level of drive	DL	10 μ W to 100 μ W	
Frequency tolerance (standard)	f _{tol}	$\pm 30 \times 10^{-6}$ (Under 5.5 MHz: $\pm 50 \times 10^{-6}$, $\pm 100 \times 10^{-6}$)	+25 °C
Frequency versus temperature characteristics (standard)	f _{tem}	Under 5.5 MHz: $\pm 50 \times 10^{-6}$	-10 °C to +60 °C
		Over 5.5 MHz: $\pm 30 \times 10^{-6}$	-20 °C to +70 °C
Load capacitance	CL	Fundamental: 10 pF to ∞ .	Please specify
		Overtone: 5 pF to ∞	
Motional resistance (ESR)	R ₁	As per table below	-20 °C to +70 °C, DL=100 μ W
Frequency aging	f _{age}	$\pm 5 \times 10^{-6}$ / year Max.	+25 °C, First year

*1 4.0 MHz \leq f_{nom} < 5.5 MHz : See "Available frequencies from 4.0 MHz to less than 5.5 MHz". 8.0 MHz < f_{nom} < 8.2 MHz: Unavailable.

*2 26.000 MHz \leq f_{nom} < 30.000 MHz : please contact us for inquiries for 3rd overtone mode.

Available frequencies from 4.0 MHz to less than 5.5 MHz (MHz)

4.000	4.032	4.096	4.190	4.194304	4.433619	4.500	4.800	4.9152
-------	-------	-------	-------	----------	----------	-------	-------	--------

Motional resistance (ESR)

Frequency (MHz)	4 \leq f _{nom} < 5.5	5.5 \leq f _{nom} < 6	6 \leq f _{nom} < 10	10 \leq f _{nom} < 12	12 \leq f _{nom} < 16	16 \leq f _{nom} < 30	30 \leq f _{nom} \leq 36	36 < f _{nom} \leq 64
Motional resistance	150 Ω Max.	100 Ω Max.	80 Ω Max.	60 Ω Max.	50 Ω Max.	40 Ω Max.	100 Ω Max.	80 Ω Max.
Overtone order	Fundamental						3rd overtone	

Product name CA-301 24.000000MHz 12.0 +10.0-10.0

(Standard form)

① ② ③ ④

①Model ②Frequency ③Load capacitance(pF) ④Frequency tolerance($\times 10^{-6}$, +25 °C)

External dimensions

(Unit:mm)

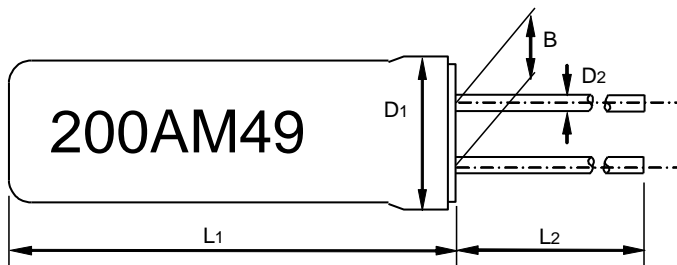

Frequency	L1	L2	D1	D2	B
Under 5.5 MHz	9.3 Max.	9.5 Min.	ϕ 3.1 Max.	ϕ 0.3	1.1
Over 5.5 MHz	8.9 Max.	9.5 Min.	ϕ 3.1 Max.	ϕ 0.3	1.1

Mouser Electronics

Authorized Distributor

Click to View Pricing, Inventory, Delivery & Lifecycle Information:

Epson:

[CA-3014.0000M-K:ROHS](#) [CA-3018.0000M-K:ROHS](#) [CA-301 8.0000M-C: PB FREE](#) [CA-301 8.0000M-K](#) [CA-301 8.388608M-C](#) [CA-301 8.4320M-C](#) [CA-301 9.6000M-C](#) [CA-301 7.3728M-C:PBFREE](#) [CA-301 9.8304M-C:PBFREE](#) [CA-301 14.0000M-C](#) [CA-301 16.0000M-D](#) [CA-301 18.0000M-C](#) [CA-301 19.6608M-C](#) [CA-301 28.3220M-C](#) [CA-301 50.0000M-K](#) [CA-301 50.0033M-K](#) [CA-301 50.0067M-K](#) [CA-301 50.0100M-K](#) [CA-301 50.0133M-C](#) [CA-301 50.0133M-K](#) [CA-301 50.0167M-K](#) [CA-301 50.0200M-C](#) [CA-301 50.0200M-K](#) [CA-301 50.0233M-K](#) [CA-301 50.0267M-K](#) [CA-301 50.0270M-C](#) [CA-301 50.0300M-K](#) [CA-301 50.0333M-K](#) [CA-301 50.0367M-K](#) [CA-301 50.0400M-C](#) [CA-301 50.0400M-K](#) [CA-301 50.0433M-K](#) [CA-301 50.0467M-K](#) [CA-301 50.0500M-K](#) [CA-301 50.0533M-K](#) [CA-301 50.0567M-K](#) [CA-301 50.0600M-K](#) [CA-301 50.0633M-K](#) [CA-301 50.0667M-K](#) [CA-301 50.0700M-K](#) [CA-301 50.0733M-K](#) [CA-301 50.0767M-K](#) [CA-301 50.0800M-K](#) [CA-301 50.0833M-K](#) [CA-301 50.0867M-K](#) [CA-301 50.0900M-K](#) [CA-301 50.0933M-K](#) [CA-301 50.0967M-K](#) [CA-301 50.1000M-K](#) [CA-301 50.1033M-K](#) [CA-301 50.1067M-K](#) [CA-301 50.1100M-K](#) [CA-301 50.1133M-K](#) [CA-301 50.1167M-K](#) [CA-301 50.1200M-K](#) [CA-301 50.1233M-K](#) [CA-301 50.1267M-K](#) [CA-301 50.1300M-K](#) [CA-301 50.1333M-K](#) [CA-301 50.1367M-K](#) [CA-301 50.1400M-K](#) [CA-301 50.1433M-K](#) [CA-301 50.1467M-K](#) [CA-301 50.1500M-K](#) [CA-301 50.1533M-K](#) [CA-301 50.1567M-K](#) [CA-301 50.1600M-K](#) [CA-301 50.1633M-K](#) [CA-301 50.1667M-C](#) [CA-301 50.1667M-K](#) [CA-301 50.1700M-K](#) [CA-301 50.1733M-K](#) [CA-301 50.1767M-K](#) [CA-301 50.1800M-K](#) [CA-301 50.1833M-K](#) [CA-301 50.1867M-K](#) [CA-301 50.1900M-K](#) [CA-301 50.1933M-K](#) [CA-301 50.1967M-K](#) [CA-301 50.2000M-K](#) [CA-301 50.2033M-K](#) [CA-301 50.2067M-K](#) [CA-301 50.2100M-K](#) [CA-301 50.2133M-K](#) [CA-301 50.2167M-K](#) [CA-301 50.2200M-K](#) [CA-301 50.2233M-K](#) [CA-301 50.2267M-K](#) [CA-301 50.2300M-K](#) [CA-301 50.2333M-K](#) [CA-301 50.2367M-K](#) [CA-301 50.2400M-K](#) [CA-301 50.2433M-K](#) [CA-301 50.2467M-K](#) [CA-301 50.2500M-K](#) [CA-301 50.2533M-K](#) [CA-301 50.2567M-K](#) [CA-301 50.2600M-K](#) [CA-301 50.2633M-K](#) [CA-301 50.2667M-K](#)